



COOK AVENUE
FLINDERS AVENUE TO
CUMBERLAND DRIVE



Digital Mapping Solutions does not warrant the accuracy of information in this publication and any person using or relying upon such information does so on the basis that DMS shall bear no responsibility or liability whatsoever for any errors, faults, defects or omissions in the information.

**COOK AVENUE
FLINDERS AVENUE TO CUMBERLAND DRIVE
LOCALITY PLAN**

23 April 2012

Not to Scale



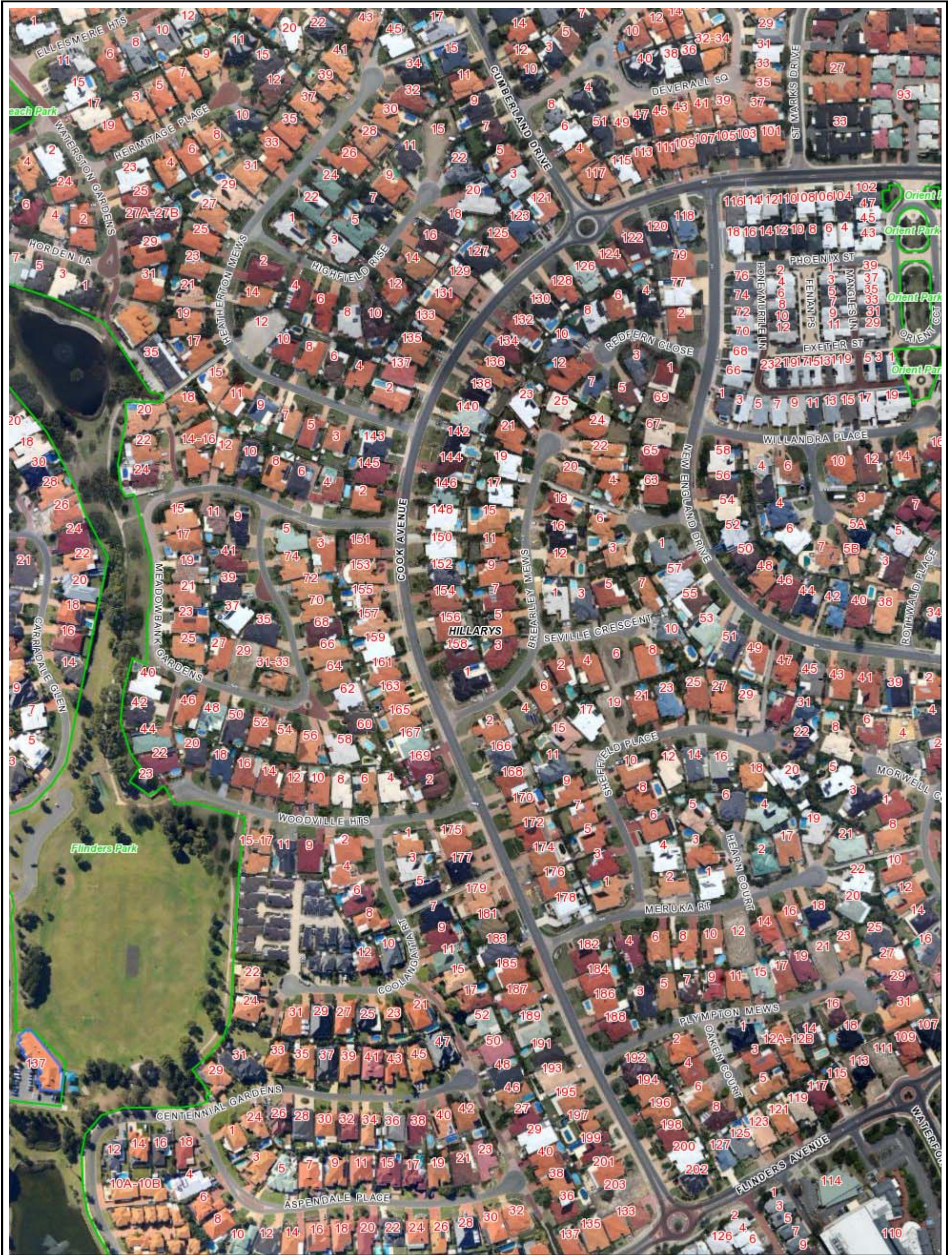

City of Joondalup
 90 Boas Ave, Joondalup WA 6027
 PO Box 21, Joondalup WA 6919
 Ph: 08 9400 4000
 Fax: 08 9300 1383
 info@joondalup.wa.gov.au
 www.joondalup.wa.gov.au

Scale(A3):Not to Scale
 Date: 2 May 2012
 N
 DISCLAIMER: While every care is taken to ensure the accuracy of this data, the City of Joondalup makes no representations or warranties about its accuracy, completeness or suitability for any particular purpose and disclaims all liability for all expenses, losses, damages and costs which you might incur as a result of the data being inaccurate or incomplete in any way and for any reason.

COOK AVENUE
FLINDERS AVENUE TO CUMBERLAND DRIVE
EXISTING ROAD LAYOUT PLAN



NOTES:

1. FULL ACCESS TO DRIVEWAYS TO BE MAINTAINED.
2. A FLUSH RED MEDIAN TREATMENT ALLOWS COOK AVE TO REMAIN CYCLE AND BUS FRIENDLY.
3. DESIGN SUBJECT TO MAIN ROADS WESTERN AUSTRALIA APPROVAL.

**COOK AVENUE
PROPOSED MEDIAN TREATMENT
CONCEPT PLAN**

SHEET 1 OF 2



**CITY OF
JOONDALUP**

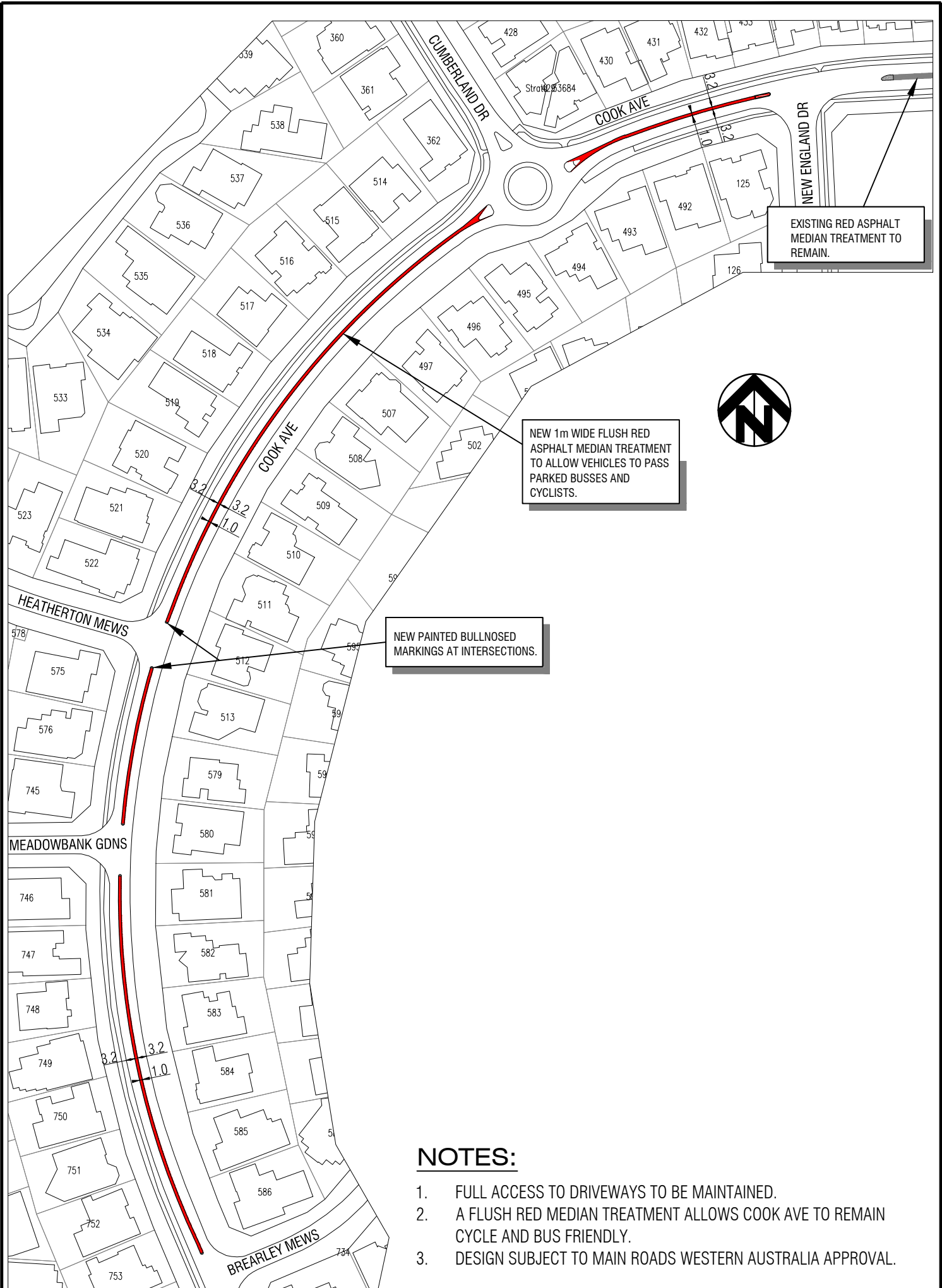

EXISTING RED ASPHALT MEDIAN TREATMENT TO REMAIN.

NEW 1m WIDE FLUSH RED ASPHALT MEDIAN TREATMENT TO ALLOW VEHICLES TO PASS PARKED BUSES AND CYCLISTS.

NEW PAINTED BULLNOSED MARKINGS AT INTERSECTIONS.



NOTES:

1. FULL ACCESS TO DRIVEWAYS TO BE MAINTAINED.
2. A FLUSH RED MEDIAN TREATMENT ALLOWS COOK AVE TO REMAIN CYCLE AND BUS FRIENDLY.
3. DESIGN SUBJECT TO MAIN ROADS WESTERN AUSTRALIA APPROVAL.

