

Subject Site
Proposed Bridge over Railway

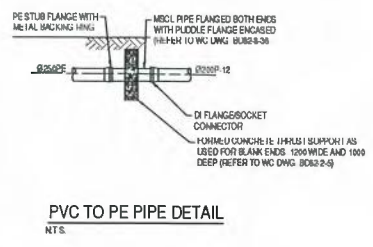

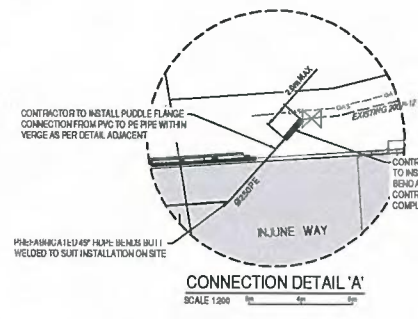
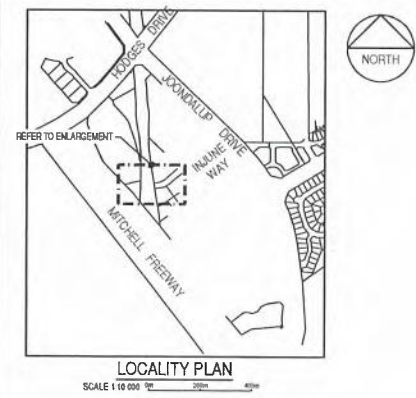

- NOTES**
- 1 ALL CO-ORDINATES SHOWN ON THIS DRAWING SHALL BE VERIFIED BY CONTRACTOR PRIOR TO COMMENCEMENT OF WORKS. ANY DISCREPANCIES TO BE REPORTED TO THE SUPERINTENDENT IMMEDIATELY.
 - 2 THIS CONTRACT INCLUDES CONSTRUCTION OF WATER MAINS AND PRELAD WATER SERVICES.
 - 3 THIS DESIGN HAS BEEN COMPLETED IN ACCORDANCE WITH THE WATER CORPORATION OF WESTERN AUSTRALIA WATER RETICULATION MANUAL (2003).
 - 4 ALL CONDUIT RINGS SHALL BE IN ACCORDANCE WITH THE LATEST WATER CORPORATION (W) OF WESTERN AUSTRALIA WATER RETICULATION MANUAL (2003). SHOULD DISCREPANCIES EXIST BETWEEN THESE NOTES AND THE WATER CORPORATION MANUAL, THE WATER CORPORATION MANUAL TAKES PRECEDENCE.
 - 5 ALL NEW CONNECTIONS TO EXISTING WATER MAINS SHALL BE CONSTRUCTED BY THE WATER CORPORATION AT THE DEVELOPER'S EXPENSE. THE CONTRACTOR SHALL CONFIRM THE LINE AND LEVEL OF THE EXISTING WATER MAINS AND NOTIFY THE SUPERINTENDENT PRIOR TO CONSTRUCTION COMMENCING/CONTINUING TO CONFIRM THE PROPOSED CONNECTION DETAIL.
 - 6 ALL NEW MAINS ARE TO BE LAID WITHIN 4.0m OF EXISTING MAINS FOR WATER CORPORATION CONNECTION.
 - 7 PIPING CONNECTION AND INSULATION SHALL BE TO WATER CORPORATION (W) OF WESTERN AUSTRALIA STANDARDS/REQUIREMENTS.
 - 8 FLUSHING POINTS TO BE INSTALLED AT ALL TEMPORARY AND PERMANENT DEAD ENDS.
 - 9 FLOR FR INDICATES THE SIDE OF THE LOT WHEN VIEWED FROM THE ROAD FRONTAGE WHICH IS SELECTED FOR THE WATER METER.
 - 10 ROAD CROSSINGS FOR SINGLE SERVICES SHALL BE 25mm ± E. LAID PRIOR TO CURBS/PAVEMENT OF THE ROAD.
 - 11 ALL D.I. PIPE FITTINGS TO BE WRAPPED IN POLYETHYLENE SHEETING.
 - 12 ALL CONSTRUCTION TO BE IN ACCORDANCE WITH WATER CORPORATION OF WESTERN AUSTRALIA STANDARD SPECIFICATIONS.
 - 13 ALL MAINS TO BE LAID ON 2m ALIGNMENT (J/S C).
 - 14 BLUE PRINT TO BE INSTALLED PERPENDICULAR TO AND OFFSET 700mm FROM THE ROAD CENTRELINE ON HYDRANT SIDE BY CONTRACTOR.
 - 15 ALL FITTINGS FOR PIPES TO CONFORM TO AS 2500.
 - 16 MANHOLE BLOCKS SHALL BE POSITIONED AND FINISHED IN ACCORDANCE WITH MANHOLE BLOCKS AND WALKER CURB/PAVEMENT OF WESTERN AUSTRALIA SPECIFICATIONS.
 - 17 THE CONTRACTOR SHALL ALLOW FOR THE SUPPLY AND INSTALLATION OF ANY ADDITIONAL FLUSHING POINTS NECESSARY FOR PRESSURE TESTING AT CONTRACTOR'S EXPENSE.

- LEGEND**
- LIMIT OF WORKS BOUNDARY
 - PROPOSED WATER MAINS TO BE CONSTRUCTED
 - PROPOSED HYDRANT VALVES TO BE INSTALLED
 - (D)P-12 PROPOSED PIPE SIZE AND CLASS
 - CHANGE OF PIPE SIZE/CLASS/ALIGNMENT
 - EXISTING MAINS AND ASSOCIATED FITTINGS
 - D" DEPTH TO SHOWN
 - HP DEAD END FLUSHING POINT WITH CAPPED END
 - ⊙ DEAD END PIPE DEFLECTED WITH HANGOFF CONNECTION
 - FITTING ITEM NUMBER

SCHEDULE OF FITTINGS

ITEM NO.	DESCRIPTION	NO. OF
1	800 x 11.25° BEND (6x12)	2
2	800 x 90° BEND (6x12)	2
3	800 CAPPED END FLUSHING POINT	2

- CONNECTIONS**
CONNECTION TO EXISTING MAINS SHALL BE BY THE WATER CORPORATION AT DEVELOPER'S EXPENSE.
- SERVICES**
- PRELAD SHORT DUAL - NA
 - PRELAD SHORT SINGLE - NA
 - PRELAD LONG DUAL - NA
 - PRELAD LONG SINGLE - NA
 - TOTAL SERVICES - NA
 - NUMBER OF LOTS SERVED - NA
 - DEFERRED SERVICES - 2

MAINS EXTENSION
CONTRACTOR TO LAY 34.8m OF 200P-12 80.5m OF 250P

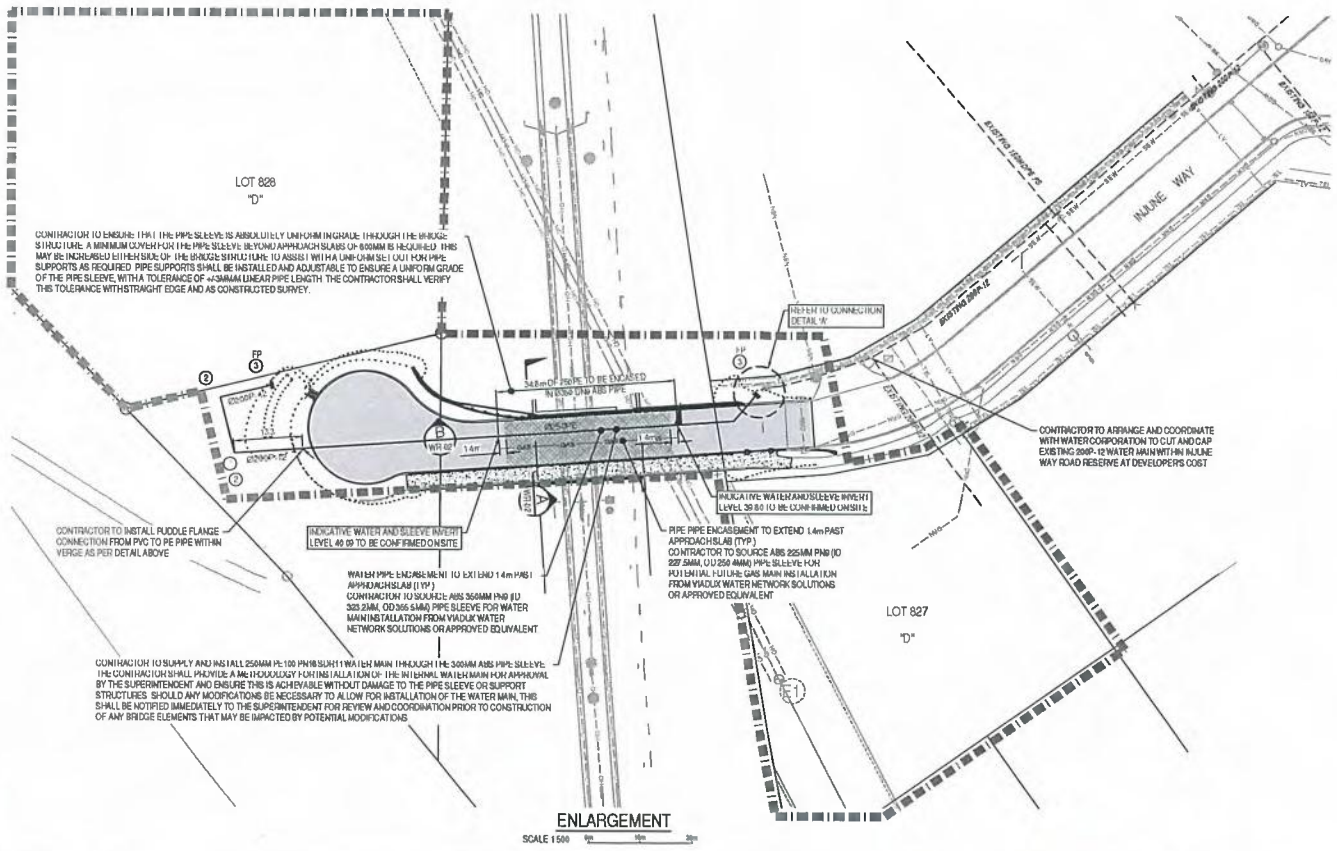

REV	DATE	DESCRIPTION	BY	CHKD
C	12/04/15	WATER DETAILS AMENDED	JL	FD
B	28/02/15	WATER AMENDED	JL	FD
A	16/02/15	INITIAL ISSUE	JL	EM

ENLARGEMENT
SCALE 1:500



430 Roberts Road
Bullambu WA 6008
Tel: 9438 2277
Fax: 9438 2278

NOT FOR CONSTRUCTION

PROJECT: MHA/24/2015
SHEET: P02
DATE: 12/04/15

THIS PLAN IS ACCEPTED AS COMPLYING WITH OVERALL SCHEME PLANNING COMPLIANCE WITH RELEVANT MANUSCRIPTS. THE RESPONSIBILITY OF THE CONSULTING ENGINEER, NO WORKS ARE TO COMMENCE ON SITE UNTIL STARTUP ARRANGEMENTS HAVE BEEN MADE WITH THE RELEVANT WORKS INSPECTOR. SEE DEVELOPER'S MANUAL FOR CONTACT DETAILS.

for MANAGER, DEVELOPMENT SERVICES _____ DATE _____

FILE No: -

PROJECT: LANDCORP PROPOSED LOT 827 & 828 INJUNE WAY, JOONDALUP
SHEET 1 OF 2
DRAWN BY: N/A
SCALE: 1:200 @ A1
PROJECT NO: 18024-C4-WR-01
DATE: 12/04/15



NOTE: IT IS THE CONTRACTOR'S RESPONSIBILITY TO REVIEW PROPOSED AND NATURAL SURFACE LEVELS AND COMPLETE ASSESSMENT OF EARTHWORKS QUANTITIES FOR THE WORKS. FROM DESIGN, IT IS ESTIMATED THAT THERE WILL BE 700m³ CUT (BANK CUBIC METRES) AND 2000m³ FILL (BANK CUBIC METERS) REQUIRED FOR THE CUL-DE-SAC AREA. THE CONTRACTOR SHALL ALLOW TO IMPORT CERTIFIED CLEAN SAND FILL FOR ANY FILL REQUIREMENTS FOR THE SITE. THE CONTRACTOR SHALL DETERMINE AND ALLOW FOR ALL BULKING OR COMPACTION FACTORS ASSOCIATED WITH EARTHWORKS WITHIN QUANTITY ASSESSMENT.

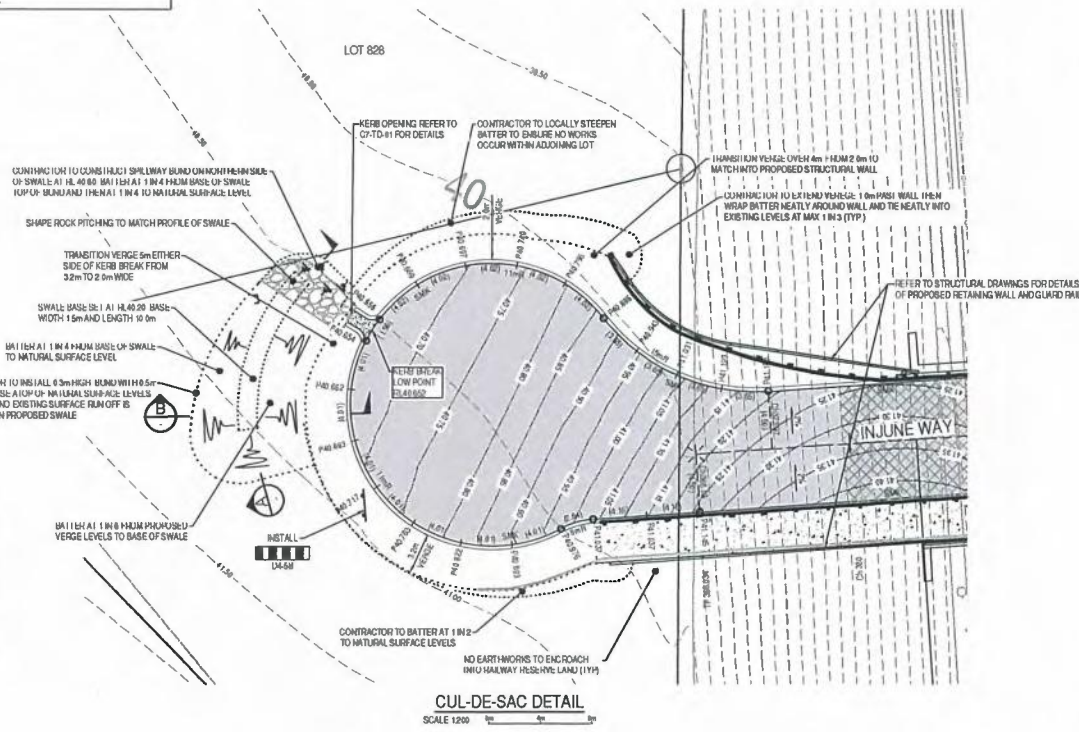

PROPOSED DRAINAGE SWALE	
BASE R/L	40.20
BASE AREA	15m x 12.5m
FLOOD WATCH LEVEL (F.W.L.)	40.60
BASIN VOLUME	20m ³
100yr ARI VOLUME	20m ³
DESIGN INFILTRATION RATE	5m ³ /day

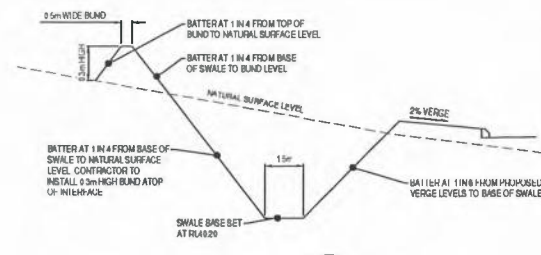
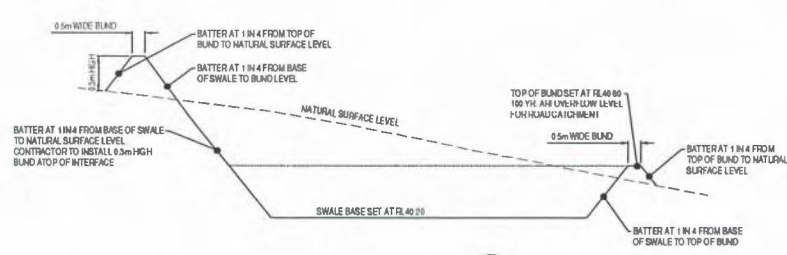

NOTES

- ALL CO-ORDINATES SHOWN ON THIS DRAWING SHALL BE VERIFIED BY CONTRACTOR PRIOR TO COMMENCEMENT OF WORKS. ANY DISCREPANCIES TO BE REPORTED TO THE SUPERINTENDENT IMMEDIATELY.
- ALL CONSTRUCTION TO BE IN ACCORDANCE WITH THE SPECIFICATIONS AND ALSO THE REQUIREMENTS OF THE CITY OF JOONDALUP.
- THE COUNCIL HAS BEEN ADVISED BY ALL RELEVANT AUTHORITIES TO LOCATE ALL EXISTING SERVICES WITHIN THE CONTRACT AREA PRIOR TO THE COMMENCEMENT OF WORK. SERVICES INFORMATION SHOWN ON THE DRAWINGS IS INDICATIVE ONLY AND MAY NOT BE COMPLETE. WHERE EXISTING AND PROPOSED WORKS CONFLICT, LEVELS ARE TO BE TAKEN AND SUPPLIED TO THE SUPERINTENDENT IMMEDIATELY.
- ALL HEIGHTS ARE TO AHD AND ALL LEVELS SHALL BE DERIVED FROM ESTABLISHED BENCHMARKS.
- ALL BENCHMARKS ARE TO BE PROTECTED AND PRESERVED.
- THE COUNCIL HAS BEEN ADVISED BY ALL RELEVANT AUTHORITIES TO LOCATE ALL EXISTING SERVICES WITHIN THE CONTRACT AREA PRIOR TO THE COMMENCEMENT OF WORK. SERVICES INFORMATION SHOWN ON THE DRAWINGS IS INDICATIVE ONLY AND MAY NOT BE COMPLETE. WHERE EXISTING AND PROPOSED WORKS CONFLICT, LEVELS ARE TO BE TAKEN AND SUPPLIED TO THE SUPERINTENDENT IMMEDIATELY.
- ALL KERB RETURNS AT INTERSECTIONS TO BE 20m RADIUS UNLESS SHOWN OTHERWISE (U.S.O).
- ALL KERBING TO BE MOUNTABLE TYPE U.S.O. KERBING ON CORNER SWEEPS TO BE SEMI MOUNTABLE U.S.O. (ALL KERBING ON A RADIUS OF 40m OR LESS MUST BE KEVED).
- TRANSITIONS BETWEEN DIFFERENT KERB TYPES SHALL BE MADE OVER A LENGTH OF 2m AND SHALL COMMENCE AT THE TANGENT POINT OF KERB RETURNS IN THE CASE OF INTERSECTIONS U.S.O.
- KERB TYPE CHANGES OCCURRING AT PROJECTIONS AND CURVES SHALL BE MADE OVER A LENGTH OF 2m AND SHALL COMMENCE AT THE TANGENT POINT OF KERB RETURNS IN THE CASE OF INTERSECTIONS U.S.O.
- ALL SETOUT POINTS AND RADII ARE TO FACE OF KERB.
- ALL CONSTRUCTION SHALL MAKE SMOOTH CONNECTION TO EXISTING WORK.
- ALL PAVEMENT TO BE CONSTRUCTED USING BLACK ASPHALT U.S.O.
- ROAD VERGES SHALL BE SURFACED WITH MINIMUM 25mm OF TOPSOIL - FREE OF DELETERIOUS MATERIAL. HYDRO MULCHING MAY BE REQUIRED AS PER DUST MANAGEMENT PLAN UNDERSIGNED AND APPROVED BY THE CITY OF JOONDALUP.
- THE COUNCIL HAS BEEN ADVISED BY THE SUPERINTENDENT WHEN ALL CONCRETE FORMWORK IS IN POSITION FOR INSPECTION AND APPROVAL, PRIOR TO THE POURING OF ANY CONCRETE.
- PEDESTRIAN CROSSINGS TO INCLUDE TACTILE PAVEMENTS AND CONSTRUCTED IN ACCORDANCE WITH THE CITY OF JOONDALUP STANDARD DRAWINGS.
- AS CONSTRUCTED DRAWINGS ARE TO BE PREPARED TO THE REQUIREMENTS OF THE CITY OF JOONDALUP.

LEGEND

- PROPOSED ROAD CENTRELINE
- PROPOSED PAVEMENT AND KERBING
- PROPOSED 50mm ASPHALT ON CONCRETE (REFER TO STRUCTURAL DRAWINGS AND SPECIFICATIONS FOR DETAILS)
- EXISTING PAVEMENT AND KERBING
- PROPOSED KERBING (TYPE DEFINED BY TEXT)
- SEMI MOUNTABLE KERB (KEVED)
- PAVEMENT LEVEL (FACE OF KERB)
- KERB SWEEP ARC SEGMENT LENGTH CHANGE
- OFFSET
- DESIGN CONTOUR (0.05m INTERVAL)
- PROPOSED CONCRETIBLE PATH
- EXISTING CONCRETE PATH
- SIGN AND POST
- PROPOSED EXTENTS OF BATTER
- PROPOSED VERGE



NO.	REV.	DATE	DESCRIPTION	BY	CHECKED
11	18/03/18		BATTERS, PATH AND BRIDGE AMENDED	JS	FO
12	13/03/18		INITIAL ISSUE	JS	FO



430 Roberts Road Joondalup WA 6009 (08) 94 7373 Sales or 08 9397 1111			
NOT FOR CONSTRUCTION			
DATE	ISSUE NO	ISSUED BY	APPROVED BY
MARCH 20 18	001	PCG/BA	AJD
REVISED BY	REVISION	DATE	BY
FO	1	18/03/18	FO
SCALE	AS SHOWN @		

PROJECT	LANDCORP LOT 827 & 828 INJUNE WAY, JOONDALUP
DESCRIPTION	ROADWORKS - INJUNE WAY INTERSECTION DETAILS
DATE	18024-C5-RJ-01
SCALE	B

Date: 25 October 2016

Your Ref:

Enquiries:

Our Ref: DA16/0578
15550

A Global City: Bold | Creative | Prosperous

Masterplan Consultants Wa Pty Ltd
Suite 7, 5 Hasler Road
OSBORNE PARK WA 6017

Dear Sir/Madam,

Reference Number: DA16/0578
Development Description: UNLISTED USE (bridge addition)
Location of Development: 350 Hodges Drive JOONDALUP WA 6027
Owner(s) Details: West Australian Land Authority (Landcorp)

I refer to your application for development approval, received by the City of Joondalup on 23 May 2016.

You are advised that approval has now been **granted** under the provisions of the *Planning and Development (Local Planning Schemes) Regulations 2015* and the *Metropolitan Region Scheme*.

Please find attached your notice of determination.

You may be required to obtain a permit from the City in accordance with the requirements of the *Building Act 2011*.

This approval does not remove the need for approvals, licences and/or permits that may be required under other legislation. The subject lot may also be affected by caveats, covenants or other private restrictions. It is recommended that you make your own enquiries in this regard.

Yours sincerely

Senior Urban Planner
Planning Services

Planning and Development Act 2005**City of Joondalup****Notice of determination on application for development approval**

Location :	350 Hodges Drive JOONDALUP WA 6027		
Legal Description :	Lot 9004 DP 402043		
Application Date :	23 May 2016	Received On :	23 May 2016

Description of proposed development:	UNLISTED USE (bridge addition)
--------------------------------------	--------------------------------

The application for development approval is:

- Approved subject to the following conditions
- Refused for the following reasons

Conditions:

- 1.1 This approval applies only to the bridge and associated works as indicated on the approved plans. It does not relate to any other development on the lot;**
- 1.2 A Construction Management Plan being submitted and approved by the City prior to the commencement of development. The management plan shall detail how it is proposed to manage:**
- 1.2.1 all forward works for the site;**
 - 1.2.2 the delivery of materials and equipment to the site;**
 - 1.2.3 the storage of materials and equipment on the site;**
 - 1.2.4 the parking arrangements for the contractors and subcontractors;**
 - 1.2.5 other matters likely to impact on the surrounding properties, and construction works shall be undertaken in accordance with the approved plan;**
- 1.3 Stormwater shall not be discharged onto the railway reserve, or Mitchell Freeway road reserve;**
- 1.4 No earthworks shall encroach onto the Mitchell Freeway road reserve;**
- 1.5 All external walls and retaining walls of the development shall be of a clean finish, and shall at all times be maintained to a high standard, including being free of vandalism, to the satisfaction of the City;**
- 1.6 Detailed plans for the bridge and associated site works shall be provided to the City prior to the commencement of construction. These plans shall incorporate measures to mitigate anti social behaviour and access to the train line, and be to the specification of the City, Main Roads WA and Department of Transport. Development shall be undertaken in accordance with these approved plans;**
- 1.7 Access to the bridge shall be restricted until such time as the development of Lot 9004 (350) Hodges Drive has commenced, to the satisfaction of the City;**

Advice Notes:

1. At its meeting held 18 October 2016 Council also resolved:

2 NOTES that the City of Joondalup will not be responsible for future maintenance of the bridge and that this responsibility will rest with Main Roads WA, upon completion of construction of the bridge.

Date of determination: 25 October 2016

Note 1: If the development the subject of this approval is not substantially commenced within a period of 2 years, or another period specified in the approval after the date of the determination, the approval will lapse and be of no further effect.

Note 2: Where an approval has so lapsed, no development must be carried out without the further approval of the local government having first been sought and obtained.

Note 3: If an applicant or owner is aggrieved by this determination there is a right of review by the State Administrative Tribunal in accordance with the *Planning and Development Act 2005* Part 14. An application must be made within 28 days of the date of determination.

Signed:

Dated:

Senior Urban Planner

25 October 2016

for and on behalf of the City of Joondalup.