

**SCHEDULE OF AREAS:**

|                                    |                   |
|------------------------------------|-------------------|
| HALL                               | 155m <sup>2</sup> |
| FOYER                              | 22m <sup>2</sup>  |
| KITCHEN                            | 17m <sup>2</sup>  |
| MEETING ROOM                       | 25m <sup>2</sup>  |
| COURTYARD                          | 12m <sup>2</sup>  |
| MATERIAL STORE                     | 4m <sup>2</sup>   |
| COMMUNITY GROUP STORE              | 8m <sup>2</sup>   |
| FURNITURE STORE                    | 14m <sup>2</sup>  |
| MALE TOILET                        | 9m <sup>2</sup>   |
| FEMALE TOILET                      | 10m <sup>2</sup>  |
| DISABLED TOILET & BABY CHANGE ROOM | 5m <sup>2</sup>   |
| STAFF TOILET                       | 2m <sup>2</sup>   |
| CLEANERS STORE                     | 2m <sup>2</sup>   |

**TOTAL AREA 285m<sup>2</sup>**

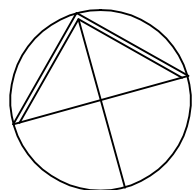
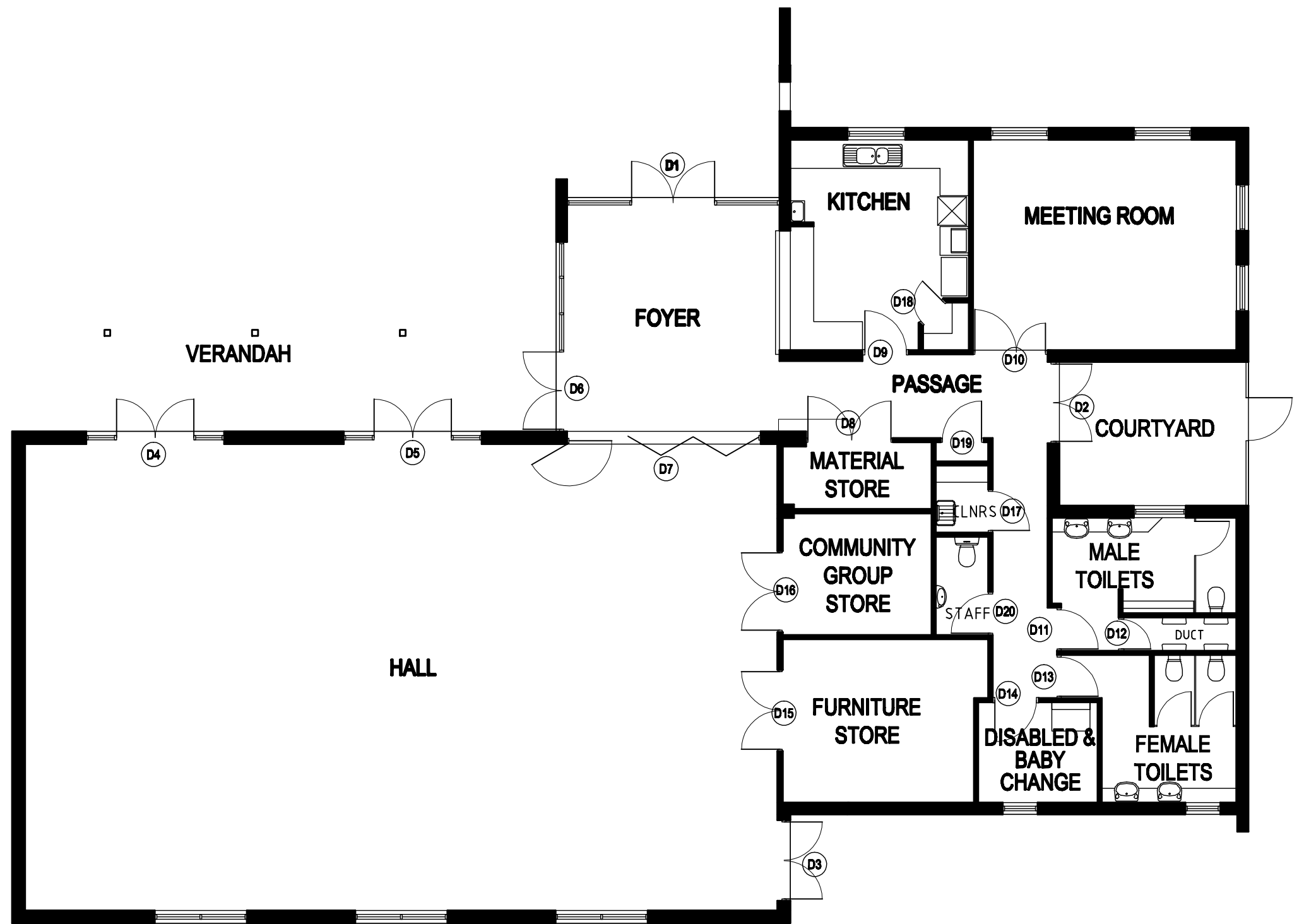

DRAWING TITLE:  
**FLOOR PLAN**

ADDRESS:  
**5 GLENELG PLACE, CONNOLLY**

*City of Joondalup*  
**Building Asset Mngmt**

PO Box 21, Joondalup  
Western Australia, 6919  
Telephone: (08) 9400 4000  
Facsimile: (08) 9400 4501



DATE:  
**JUNE 11**  
SCALE:  
**1:100**  
DRAWN:  
**D.W**

BUILDING No:  
**1010**  
DRAWING No:  
**A001**

BUILDING NAME:  
**CONNOLLY COMMUNITY CENTRE**

THIS DRAWING TO BE PLOTTED ON A3 SIZE PAPER - DO NOT SCALE, IF IN DOUBT ENQUIRE WITH ASSET MGT 94004340

THIS DRAWING IS THE PROPERTY OF THE CITY OF JOONDALUP BUILDING ASSET MANAGEMENT AND MAY NOT BE COPIED OR USED WITHOUT CONSENT. CHECK ALL DIMENSIONS BEFORE FABRICATION AND AGAINST ON SITE DIMENSIONS