

SCHEDULE OF AREAS:

FOYER	31m ²
COMMUNITY GROUP STORE 1	12m ²
COMMUNITY GROUP STORE 2	12m ²
COMMUNITY GROUP STORE 3	2m ²
MALE TOILET	6m ²
FEMALE TOILET	7m ²
KITCHEN	16m ²
HALL	145m ²
TOTAL AREA	231m²

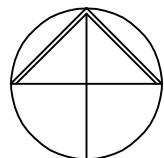
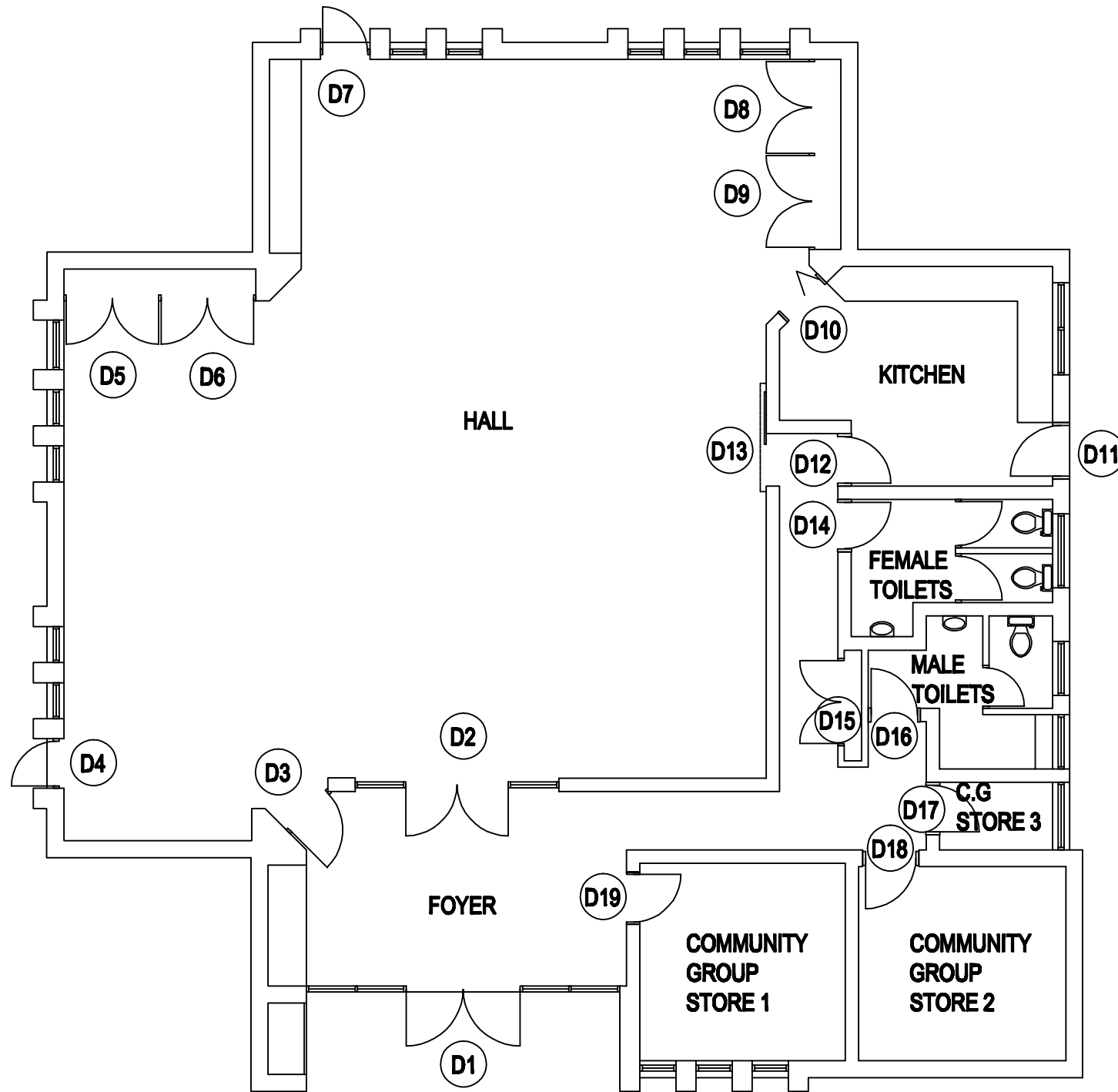

DRAWING TITLE:
FLOOR PLAN

ADDRESS:
2 DORCHESTER AVENUE, WARWICK

City of Joondalup
Building Asset Mngmt

PO Box 21, Joondalup
Western Australia, 6919
Telephone: (08) 9400 4000
Facsimile: (08) 9400 4501



DATE:
JUNE 11
SCALE:
1:100
DRAWN:
D.W

BUILDING No:
1054
DRAWING No:
A001

BUILDING NAME:
DORCHESTER
HALL

THIS DRAWING TO BE PLOTTED ON A3 SIZE PAPER - DO NOT SCALE, IF IN DOUBT ENQUIRE WITH ASSET MGT 94004340

THIS DRAWING IS THE PROPERTY OF THE CITY OF JOONDALUP BUILDING ASSET MANAGEMENT AND MAY NOT BE COPIED OR USED WITHOUT CONSENT. CHECK ALL DIMENSIONS BEFORE FABRICATION AND AGAINST ON SITE DIMENSIONS