

# WHITFORD SENIOR CITIZENS CENTRE

## SCHEDULE OF AREAS:

HAIRDRESSER	29m <sup>2</sup>
PODIATRIST	17m <sup>2</sup>
SENIORS OFFICE	26m <sup>2</sup>
FOYER	51m <sup>2</sup>
MALE TOILET	12m <sup>2</sup>
FEMALE TOILET	17m <sup>2</sup>
CLEANER STORE	6m <sup>2</sup>
SENIORS ACTIVITY ROOM	58m <sup>2</sup>
ACTIVITY ROOM 1	38m <sup>2</sup>
ACTIVITY ROOM 2	43m <sup>2</sup>
DINING	37m <sup>2</sup>
FURNITURE STORE	6m <sup>2</sup>
SENIOR STORE 1	5m <sup>2</sup>
SENIOR STORE 2	5m <sup>2</sup>
SENIOR STORE 3	7m <sup>2</sup>
KITCHEN	21m <sup>2</sup>
COURTYARD	90m <sup>2</sup>
HALL	214m <sup>2</sup>
STAGE	30m <sup>2</sup>
<b>TOTAL AREA</b>	<b>712m<sup>2</sup></b>

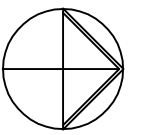
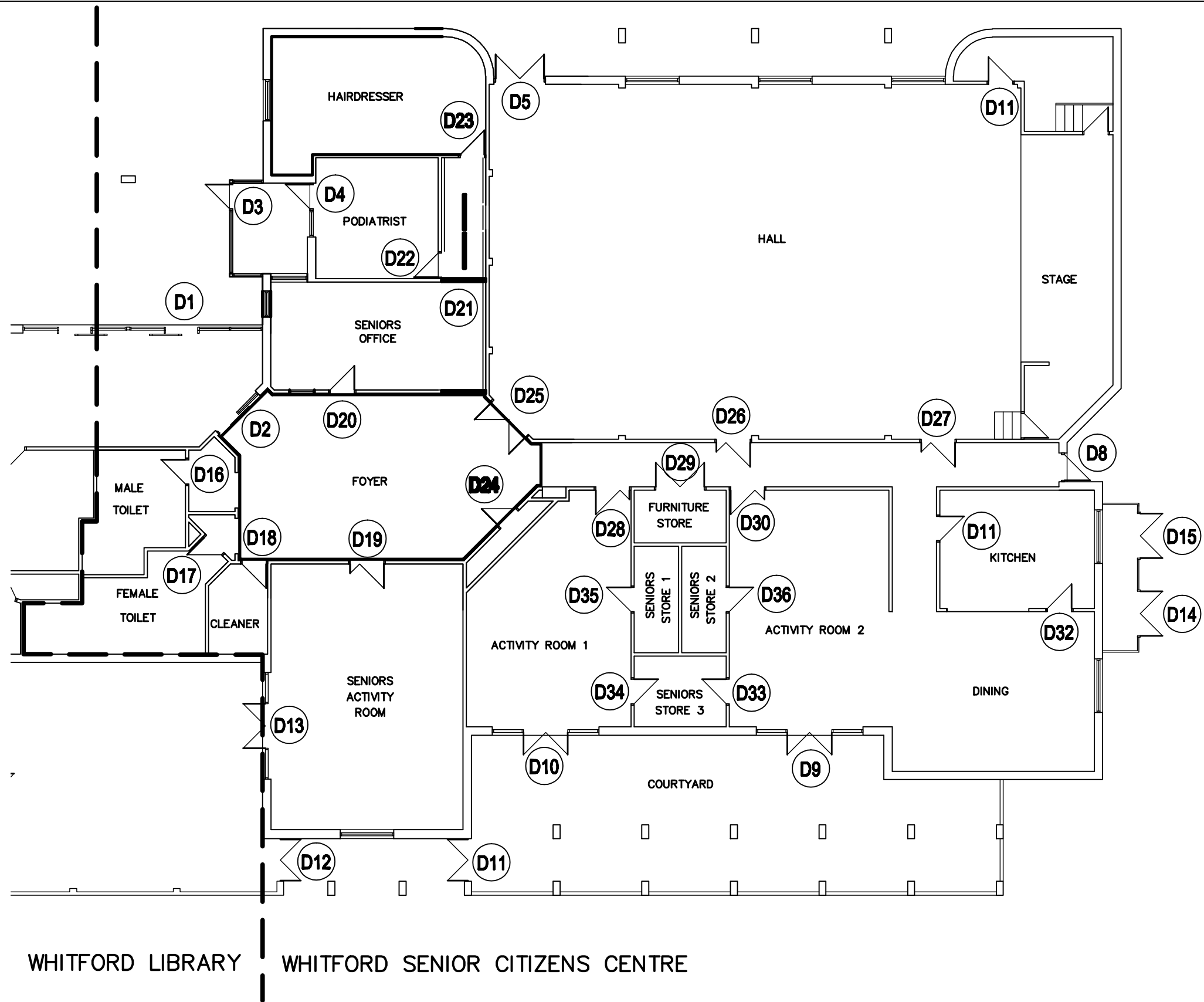

<b>DRAWING TITLE:</b> <b>FLOOR PLAN</b>	<b>ADDRESS:</b> <b>15 BANKS AVENUE, HILLARYS</b>	<b>City of Joondalup</b> <b>Building Asset Mngmt</b> PO Box 21, Joondalup Western Australia, 6919 Telephone: (08) 9400 4000 Facsimile: (08) 9400 4501	<b>DATE:</b> <b>JUNE 11</b> <b>SCALE:</b> <b>1:150</b> <b>DRAWN:</b> <b>D.W</b>	<b>BUILDING No:</b> <b>1037</b> <b>DRAWING No:</b> <b>A001</b>	<b>BUILDING NAME:</b> <b>WHITFORD SENIOR CITIZENS CENTRE</b>
<small>THIS DRAWING TO BE PLOTTED ON A3 SIZE PAPER - DO NOT SCALE, IF IN DOUBT ENQUIRE WITH ASSET MGT 94004340</small>	<small>THIS DRAWING IS THE PROPERTY OF THE CITY OF JOONDALUP BUILDING ASSET MANAGEMENT AND MAY NOT BE COPIED OR USED WITHOUT CONSENT. CHECK ALL DIMENSIONS BEFORE FABRICATION AND AGAINST ON SITE DIMENSIONS</small>				